

# 525 Cold Cathode Ionization Gauge Tube (non-bakeable)

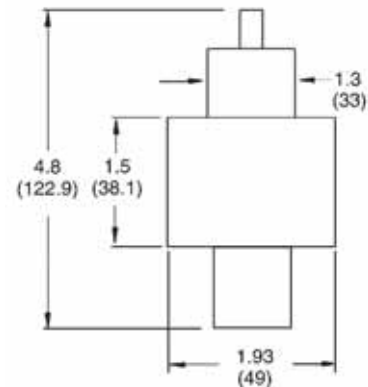

The 525 Cold Cathode Ionization Gauge Tube measures pressures from  $1 \times 10^{-8}$  to  $1 \times 10^{-2}$  Torr ( $1 \times 10^{-8}$  to  $1 \times 10^{-2}$  mbar) and has excellent repeatability, accuracy, and reliability. Sudden exposures to atmospheric pressure will not cause any damage. Similar in configuration to the magnetron tube, the 525 starts at very low pressures where ordinary cold cathode gauges are difficult to start.

## Outline Drawing



1. KF adds 0.15" to length
2. CFF adds 0.25" to length

Dimensions: inches (millimeters)

## Technical Specifications

### Response Time

Full scale to half scale pressure change: less than one second

### Range

$1 \times 10^{-8}$  torr to  $1 \times 10^{-2}$  torr  
( $1 \times 10^{-8}$  mbar to  $10^{-2}$  mbar)

### Bakeability

100 °C

### Materials

Aluminum cathode, stainless steel shell, glass

### Recommended Controllers

860 and 860-2, Multi-gauge, and senTorr Gauge Controllers

## Ordering Information

Description	Part Number	Fitting	Shipping Weight lbs. (kg)
525 Cold Cathode Gauge Tube	K9234301	1 in. tubulation	2.0 (1.0)
	K9234311	NW25 KF flange	2.0 (1.0)
	K9234302	NW40 KF flange	2.0 (1.0)
	K9234303	2.75 CF	2.0 (1.0)
525 Gauge tube maintenance kit	K9440301		2.0 (1.0)